

## Proximity Sensors

Section 18



## Photoelectric Sensors

Section 19



## IEC Limit Switches

Section 20



## Encoders

Section 21



## Current Sensors

Section 22



## Pressure Sensors

Section 23



## Temperature Sensors

Section 24



**In this interactive PDF  
you can:**

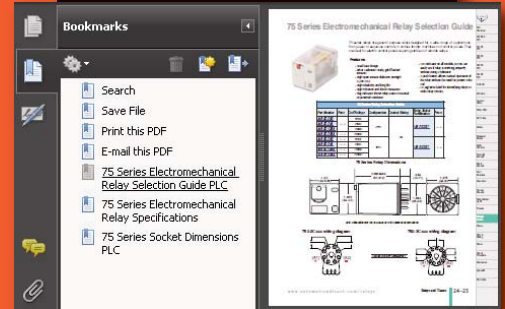

- Use bookmarks to navigate by product category
- Use bookmarks to save, search, print or e-mail the catalog section
- Click on part #s to link directly to our online store for current pricing, specs, stocking information and more



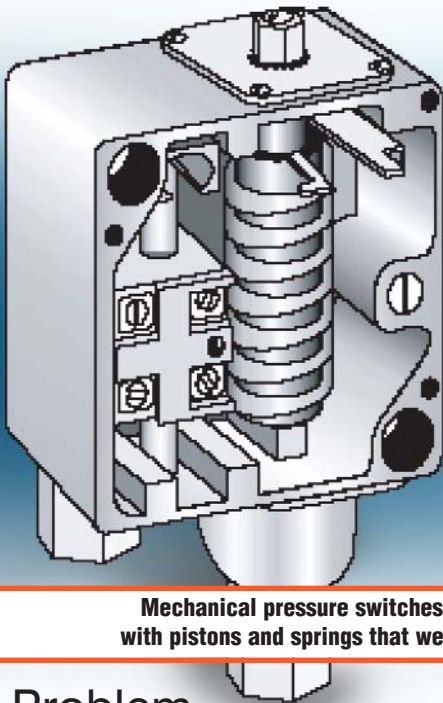

**Mechanical pressure switches  
with pistons and springs that wear**



## Problem

ProSense pressure sensors are designed to monitor system pressure in hydraulic and pneumatic applications. Vacuum sensors provide an accurate readout of increases and decreases in vacuum systems. With no moving parts such as pistons or springs that can stick or break, ProSense pressure and vacuum sensors are a solid-state solution to mechanical switches. These sensors are smaller and easier to install than traditional mechanical pressure switches. This is due to flexible film circuitry that enables the system components to be mounted on flexible film rather than a rigid circuit board. The film is then rolled and placed inside a compact, stainless steel housing. ProSense offers pressure sensing solutions using capacitive sensing technology and strain gauge technology. The capacitive sensing technology sensors incorporate the same ceramic pressure measuring cell sensing technology found in high accuracy pressure transmitters. These sensors have a quick disconnect M12 connector with 4 pins and use the AutomationDirect M12 cables.

## Pressure and vacuum transmitters

The compact PTD Series pressure and vacuum transmitters provide an analog output for reliable pressure indication. The transmitters offer quick installation and easy setup.

Pressure transmitter ranges up to 3000 psi are available with output options of 4 to 20 mA or 0 to 10 Volts.

Models with a range of 0 to 100 inches water column are also available.

Vacuum-style transmitters offer 20 to 4mA or 10 to 0 Volt outputs from -14.5 to 0 psi.

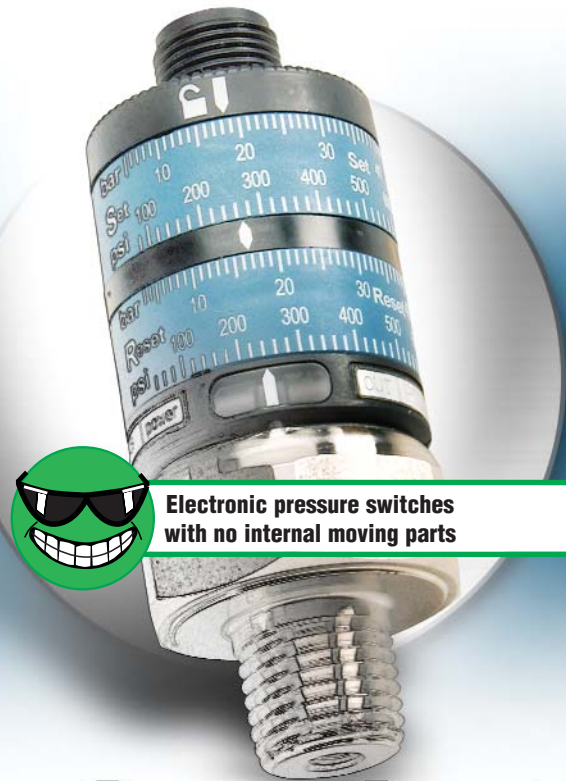

**Electronic pressure switches  
with no internal moving parts**

## Solution!

### Pressure switches use strain gauge technology

The PSD series electronic pressure switch is an ideal alternative to mechanical piston pressure switches. The PSD sensor features a gas-tight measuring cell that reliably detects gas and liquid pressure. The switch withstands aggressive media and detects pressure ranges up to 5800 psi (400 bar). The use of thick-film strain gauge technology results in a one-piece welded measuring cell capable of over 50 million switching cycles. The strain gauge and the measuring diaphragm detect the strain created by pressure changes through a Wheatstone bridge. The strain is proportional to the applied pressure. Mechanical adjustment dials rotate quickly to establish the setpoint and reset point. The sensor is adjustable without system pressure and supply voltage and does not require calibration. The sensor's high accuracy and long-term stability ensure the setpoint does not drift.

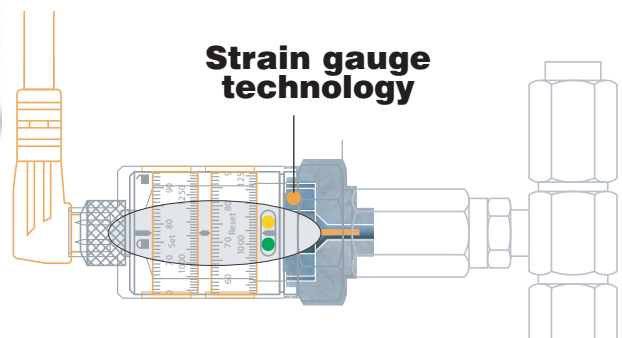

**Strain gauge  
technology**



## Absolute, gauge and vacuum scales

Atmospheric pressure is the air pressure exerted upon the earth. It is approximately 14.7 psi at sea level and decreases as elevation increases. The gauge pressure scale uses atmospheric pressure as the zero point and extends in the positive direction. ProSense pressure sensors use the gauge pressure scale. Models rated to 400 psi (25 bar) or less have a vent that allows the zero point to change as atmospheric pressure changes. This allows the sensor to stay within the accuracy specifications. Models rated above 400 psi (25 bar) are sealed to local

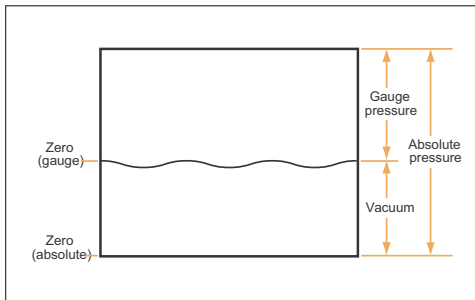

atmospheric pressure at the manufacturing site when they are assembled. The pressure ranges for these models are large enough that changes in atmospheric pressure will not affect the accuracy specifications. The vacuum scale ranges from absolute zero pressure to atmospheric pressure. The absolute zero pressure point, which is also called total vacuum, represents a total lack of pressure. ProSense vacuum sensors require the switch setpoint to always be at a higher pressure (lower vacuum) than the reset point. The absolute pressure scale also uses the absolute zero pressure point as its base line or zero point. Its range extends through the vacuum scale into positive pressure.

**AutomationDirect does not offer pressure sensors that measure absolute or differential pressure.**



## Adjustable hysteresis (pressure switches only)

Hysteresis is the difference between the setpoint and the reset point. The setpoint and reset point can be established individually at almost any value within the operating range, as long as the minimum hysteresis value of the sensor is met (the minimum hysteresis value is normally 2% of the operating range).

For example, a normally open switch with a setpoint of 70% of range and a reset point of 20% of range has a hysteresis of 50% of the range. The setpoint and the reset point are set using the two rings on the switch.

The example below shows a hysteresis mode, normally open and normally closed sensor with SP = 70%, RP = 20%.

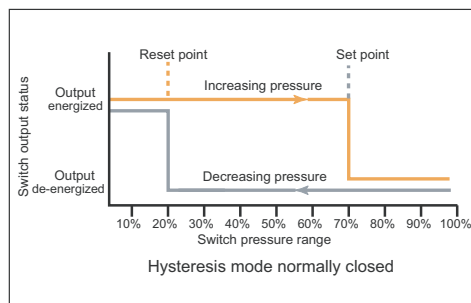
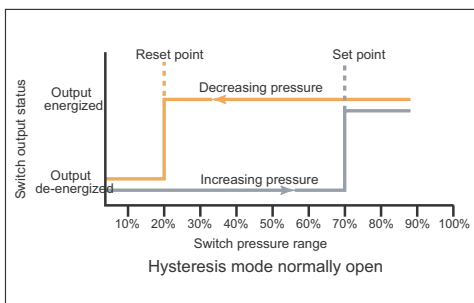

# proSense<sup>TM</sup> PSD25 Series Pressure Switches



## Features

- Compact pressure switch features simple setup using mechanical adjustment dials
- Extremely durable housing with 316 stainless steel process connection
- No moving parts ensure long-term stability without setpoint drift
- LEDs indicate switching and operating status
- Complementary switching outputs (N.O./N.C.), DC
- Easy set-up dials
- Vibration and shock-resistant

## Agency Approvals

- cULus, File number E320431
- CE
- RoHS



ProSense Series Pressure Sensors					
Part Number	Description	Pcs/Pkg	Wt(lb)	Price	Cable Assemblies
PSD25-0P-0145H	Pressure switch, DC, PNP NO/NC, 7.5 to 145 psi range, 1/4" NPT male port	1	0.21	<--->	CD12L-0B-020-A0 CD12L-0B-020-C0 CD12M-0B-070-A1 CD12M-0B-070-C1 (order separately - see Proximity Sensor section for cable specs)
PSD25-0P-1450H	Pressure switch, DC, PNP NO/NC, 75 to 1450 psi range, 1/4" NPT male port	1	0.21	<--->	
PSD25-0P-5800H	Pressure switch, DC, PNP NO/NC, 290 to 5800 psi range, 1/4" NPT male port	1	0.21	<--->	
Accessory					
PSD-CV	Transparent plastic protective cap for PSD series	1	0.01	<--->	PSD Series Sensors

**Note:** Check the chemical compatibility of the sensor's wetted parts with the medium to be measured.

ProSense PSD25 Series Technical Specifications	
<b>Operating Voltage</b>	9.6 to 32 VDC
<b>Connection Pin Material</b>	Gold-plated
<b>Output Maximum Load Current</b>	500 mA - See Setting and Operation Guide on following page.
<b>Current Consumption</b>	< 25 mA
<b>Switching Frequency</b>	100 Hz
<b>Setting Accuracy of Switch Points</b>	< ± 2.5% of full range (limit point calibration)
<b>Repeatability</b>	< ± 0.5% of full range
<b>Temperature Drift</b>	< ± 0.5%, of full temperature range/10 K; 32 to 176°F (0 to 80°C).
<b>Housing Material</b>	PBT (Pocan); PC (Makrolon); FPM (Viton); stainless steel (316S12)
<b>Materials (wetted parts)</b>	Stainless steel (316S12)
<b>Operating Temperature</b>	-13 to 176°F (-25 to 80°C)
<b>Medium Temperature</b>	-13 to 176°F (-25 to 80°C)
<b>Storage Temperature</b>	-40 to 212°F (-40 to 100°C)
<b>Protection</b>	IP 67
<b>Protection Class</b>	III
<b>Insulation Resistance</b>	> 100 MΩ (500 VDC)
<b>Shock Resistance</b>	50g (DIN / IEC 68-2-27, 11ms)
<b>Vibration Resistance</b>	20g (DIN / IEC 68-2-6, 10 - 2000 Hz)
<b>EMC</b>	
<b>EN 61000-4-2 ESD</b>	4 kV/8 kV AD
<b>EN 61000-4-3 HF Radiated</b>	10 V/m
<b>EN 61000-4-4 Burst</b>	2 kV
<b>EN 61000-4-6 HF Conducted</b>	10 V

Applications (Type of Pressure: Relative Pressure, Liquids and Gases)				
Part Number	Setpoint Scale	Resetpoint Scale	Permissible Overload Pressure	Bursting Pressure
	bar (PSI)	bar (PSI)	bar (PSI)	bar (PSI)
<b>PSD25-0P-5800H</b>	20 to 400 (290 to 5800)	12 to 392 (175 to 5685)	600 (8700)	1600 (23200)
<b>PSD25-0P-1450H</b>	5 to 100 (75 to 1450)	3 to 98 (50 to 1420)	200 (2900)	1000 (14500)
<b>PSD25-0P-0145H</b>	0.5 to 10 (7.5 to 145)	0.3 to 9.8 (5 to 142)	25 (362)	300 (4350)

**Note:** Full vacuum permissible



**WARNING! AVOID STATIC AND DYNAMIC OVERPRESSURE EXCEEDING THE GIVEN OVERLOAD PRESSURE. EXCEEDING THE BURSTING PRESSURE FOR EVEN A SHORT TIME CAN CAUSE DESTRUCTION OF THE UNIT AND POSSIBLE INJURIES!**



## Switch Dimensions

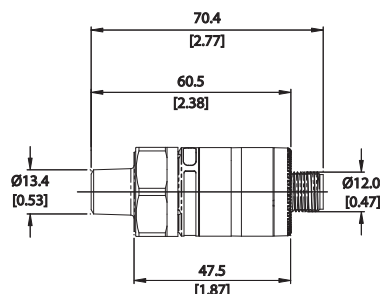

Note: tightening torque 25 Nm (18.4 lb-ft)

## Switch Cover Dimensions

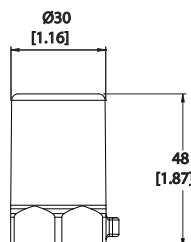
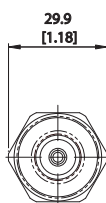

Dimensions shown mm [inches]

## PSD25 Wiring Diagrams

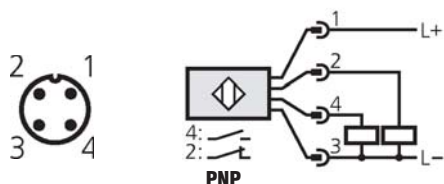

### Cable Assembly Wiring Colors:

Pin 1 - Brown

Pin 2 - White

Pin 3 - Blue

Pin 4 - Black

Note: wiring colors are based on AutomationDirect CD12L and CD12M 4-pole cable assemblies.

## Setting and Operation

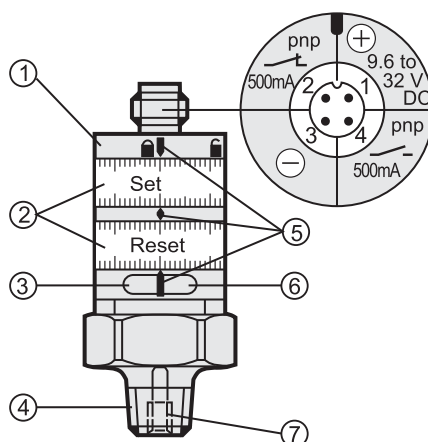

1. locking ring
  2. setting rings (manually adjustable after unlocking)
  3. LED green: supply voltage O. K.
  4. process connection 1/4" NPT; tightening torque 25 Nm
  5. setting marks
  6. LED yellow: Set value reached, OUT1 = ON / OUT2 = OFF
  7. internal thread M5
- Minimum distance between Set and Reset = 2% of the final value of the measuring range.
  - To obtain the setting accuracy: Set both rings to the minimum value, then set the requested values.

# proSense™ PTD25 Series Pressure Transmitters

by AUTOMATIONDIRECT

## Features

The pressure sensor detects the system pressure and converts it into an analog output signal.

- Ceramic sensing element provides high burst/overpressure protection
- Output options: 4-20 mA or 0-10 V
- Analog output via 4-pin Micro DC connector
- Flexible film circuit results in excellent shock and vibration resistance
- Robust stainless steel housing

## Agency Approvals

- cULus File number E320431
- CE
- RoHS



**NOTE: CHECK THE CHEMICAL COMPATIBILITY OF THE SENSOR'S WETTED PARTS WITH THE MEDIUM TO BE MEASURED. FOR GASEOUS MEDIA, LIMIT THE PROCESS PRESSURE TO 363 PSI (25 BAR) MAXIMUM.**

### ProSense Series Pressure Transmitters

Part Number	Description	Pcs/Pkg	Wt(lb)	Price	Cable Assemblies
<b>PTD25-10-VH</b>	Vacuum transmitter, 10 to 0 V output, -14.5 to 0 psi range vacuum, 1/4" NPT male port	1	0.48	<--->	CD12L-0B-020-A0 CD12L-0B-020-C0 CD12M-0B-070-A1 CD12M-0B-070-C1  (order separately - see Proximity Sensor section for cable specs)
<b>PTD25-10-0100WCH</b>	Pressure transmitter, 0 to 10 V output, 0 to 100 inches wc* range, 1/4" NPT male port	1	0.48	<--->	
<b>PTD25-10-0015H</b>	Pressure transmitter, 0 to 10 V output, 0 to 15 psi range, 1/4" NPT male port	1	0.48	<--->	
<b>PTD25-10-0030H</b>	Pressure transmitter, 0 to 10 V output, 0 to 30 psi range, 1/4" NPT male port	1	0.48	<--->	
<b>PTD25-10-0100H</b>	Pressure transmitter, 0 to 10 V output, 0 to 100 psi range, 1/4" NPT male port	1	0.48	<--->	
<b>PTD25-10-0200H</b>	Pressure transmitter, 0 to 10 V output, 0 to 200 psi range, 1/4" NPT male port	1	0.48	<--->	
<b>PTD25-10-0500H</b>	Pressure transmitter, 0 to 10 V output, 0 to 500 psi range, 1/4" NPT male port	1	0.48	<--->	
<b>PTD25-10-1000H</b>	Pressure transmitter, 0 to 10 V output, 0 to 1000 psi range, 1/4" NPT male port	1	0.48	<--->	
<b>PTD25-10-3000H</b>	Pressure transmitter, 0 to 10 V output, 0 to 3000 psi range, 1/4" NPT male port	1	0.48	<--->	
<b>PTD25-20-VH</b>	Vacuum transmitter, 20 to 4 mA output, -14.5 to 0 psi range vacuum, 1/4" NPT male port	1	0.48	<--->	
<b>PTD25-20-0100WCH</b>	Pressure transmitter, 4 to 20mA output, 0 to 100 inches wc* range, 1/4" NPT male port	1	0.48	<--->	
<b>PTD25-20-0015H</b>	Pressure transmitter, 4 to 20 mA output, 0 to 15 psi range, 1/4" NPT male port	1	0.48	<--->	
<b>PTD25-20-0030H</b>	Pressure transmitter, 4 to 20 mA output, 0 to 30 psi range, 1/4" NPT male port	1	0.48	<--->	
<b>PTD25-20-0100H</b>	Pressure transmitter, 4 to 20 mA output, 0 to 100 psi range, 1/4" NPT male port	1	0.48	<--->	
<b>PTD25-20-0200H</b>	Pressure transmitter, 4 to 20 mA output, 0 to 200 psi range, 1/4" NPT male port	1	0.48	<--->	
<b>PTD25-20-0500H</b>	Pressure transmitter, 4 to 20 mA output, 0 to 500 psi range, 1/4" NPT male port	1	0.48	<--->	
<b>PTD25-20-1000H</b>	Pressure transmitter, 4 to 20 mA output, 0 to 1000 psi range, 1/4" NPT male port	1	0.48	<--->	
<b>PTD25-20-3000H</b>	Pressure transmitter, 4 to 20 mA output, 0 to 3000 psi range, 1/4" NPT male port	1	0.48	<--->	

### ProSense PTD25 Series General Specifications

\*wc = water column

<b>Housing Material</b>	Stainless steel (316S12); FPM (Viton); PA; EPDM/X (Santoprene)
<b>Materials (wetted parts)</b>	Stainless steel (303S22); ceramics; FPM (Viton)
<b>Operating Temperature</b>	-13 to 176°F (-25 to 80°C)
<b>Medium Temperature</b>	-13 to 194°F (-25 to 90°C)
<b>Storage Temperature</b>	-40 to 212°F (-40 to 100°C)
<b>Protection</b>	IP 68 / IP 69K (Units with pressure range 1000 PSI and higher)
<b>Protection</b>	IP 65 (Units with pressure range 500 PSI and lower)
<b>Protection Class</b>	III
<b>Accuracy</b>	< ± 0.75% of full range
<b>Repeatability</b>	< ± 0.15% of full range
<b>Insulation Resistance</b>	> 100 MΩ: (500 V DC)
<b>Shock Resistance</b>	50g (DIN / IEC 68-2-27, 11ms)
<b>Vibration Resistance</b>	20g (DIN / IEC 68-2-6, 10 - 2000 Hz)
<b>EMC (PTD25-10-xxxxx)</b>	
<b>EN 61000-4-2 ESD</b>	4 kV/8 kV AD
<b>EN 61000-4-3 HF Radiated</b>	30 V/m
<b>EN 61000-4-4 Burst</b>	2 kV
<b>EN 61000-4-6 HF Conducted</b>	10 V
<b>EMC (PTD25-20-xxxxx)</b>	
<b>EN 61000-4-2 ESD</b>	4 kV/8 kV AD
<b>EN 61000-4-3 HF Radiated</b>	30 V/m
<b>EN 61000-4-4 Burst</b>	2 kV
<b>EN 61000-4-6 HF Conducted</b>	10 V
<b>Radiation of Interference</b>	2004/104/EC / CISPR25, according to the road vehicle guideline
<b>Noise Immunity</b>	2004/104/EC / ISO 11452-2, according to the road vehicle guideline
<b>HF Conducted</b>	100 V/m
<b>Pulse Resistance</b>	According to ISO7637-2: Severity level 3

# proSense™ PTD25 Pressure Transmitters

by AUTOMATIONDIRECT



Company Information

Systems Overview

Programmable Controllers

Field I/O

Software

C-more & other HMI

Drives

Soft Starters

Motors & Gearbox

Steppers/ Servos

Motor Controls

Proximity Sensors

Photo Sensors

Limit Switches

Encoders

Current Sensors

Pressure Sensors

Temperature Sensors

Pushbuttons/ Lights

Process

Relays/ Timers

Comm.

Terminal Blocks & Wiring

Power

Circuit Protection

Enclosures

Tools

Pneumatics

Appendix

Product Index

Part # Index

ProSense PTD25 Series Technical Specifications	
Technical Specifications PTD25-10-xxxx	
Operating Voltage PTD25-10-xxxx	16 to 32 VDC <sup>1</sup>
Current Consumption	< 18 mA
Analog Output	0 to 10 V (min/max 0 to 10.5V)
Minimum Load	2000 Ω
Step Response Time Analog Output	3 ms
Technical Specifications PTD25-20-xxxx	
Operating Voltage PTD25-20-xxxx	9.6 to 32 VDC
Analog Output	4 to 20 mA (min/max 3.85 to 22 mA)
Maximum Load	[(supply voltage - 9.6) x 50]Ω. For example: [(24 VDC - 9.6) x 50] = 720Ω
Step Response Time Analog Output	3 ms
Characteristics Deviation (in % of full range)*	
PTD25-xx-3000H	< ± 0.35 (BFSL) / < ± 0.75 (FR)
PTD25-xx-1000H	< ± 0.35 (BFSL) / < ± 0.75 (FR)
PTD25-xx-0500H	< ± 0.35 (BFSL) / < ± 0.75 (FR)
PTD25-xx-0200H	< ± 0.35 (BFSL) / < ± 0.75 (FR)
PTD25-xx-0100H	< ± 0.35 (BFSL) / < ± 0.75 (FR)
PTD25-xx-0030H	< ± 0.35 (BFSL) / < ± 0.75 (FR)
PTD25-xx-0015H	< ± 0.25 (BFSL) / < ± 0.5 (FR)
PTD25-xx-0100WCH	< ± 0.35 (BFSL) / < ± 0.75 (FR)
PTD25-xx-VH	< ± 0.25 (BFSL) / < ± 0.5 (FR)
Repeatability (in % of full range)	
PTD25-xx-3000H	< 0.15
PTD25-xx-1000H	< 0.15
PTD25-xx-0500H	< 0.15
PTD25-xx-0200H	< 0.15
PTD25-xx-0100H	< 0.15
PTD25-xx-0030H	< 0.15
PTD25-xx-0015H	< 0.1
PTD25-xx-0100WCH	< 0.15
PTD25-xx-VH	< 0.1
Temperature Coefficients (TEMPCO) Greatest TEMPCO of the zero point of full range	
PTD25-xx-3000H	Temperature range 0 to 80°C (-13 to 176°F) [in % of full range/10°C(50°F)] 0.2 / 0.3
PTD25-xx-1000H	0.2 / 0.3
PTD25-xx-0500H	0.15 / 0.2
PTD25-xx-0200H	0.15 / 0.2
PTD25-xx-0100H	0.2 / 0.3
PTD25-xx-0030H	0.2 / 0.3
PTD25-xx-0015H	0.15 / 0.2
PTD25-xx-0100WCH	0.2 / 0.3
PTD25-xx-VH	0.15 / 0.2
<sup>1</sup> ) per EN50178, SELV, PELV	
*Note: BFSL = Best Fit Straight Line / FR = Full Range	

Applications (Type of Pressure: Relative Pressure, Liquids and Gases)			
Part Number	Measuring Range PSI	Permissible Overload Pressure PSI	Bursting Pressure PSI
PTD25-10-3000H	0 to 3000	5800	12300
PTD25-20-3000H			
PTD25-10-1000H	0 to 1000	4350	9400
PTD25-20-1000H			
PTD25-10-0500H	0 to 500	2175	5075
PTD25-20-0500H			
PTD25-10-0200H	0 to 200	1087	2175
PTD25-20-0200H			
PTD25-10-0100H	0 to 100	1087	2175
PTD25-20-0100H			
PTD25-10-0030H	0 to 30	290	725
PTD25-20-0030H			
PTD25-10-0015H	0 to 15	145	450
PTD25-20-0015H			
PTD25-10-VH	-14.5 to 0 (vacuum)	145	450
PTD25-20-VH			
	inH <sub>2</sub> O	inH <sub>2</sub> O	inH <sub>2</sub> O
PTD25-10-0100WCH	0 to 100	4015	12043
PTD25-20-0100WCH			

inH<sub>2</sub>O = Inches of Water (represents Water Column)

## Dimensions

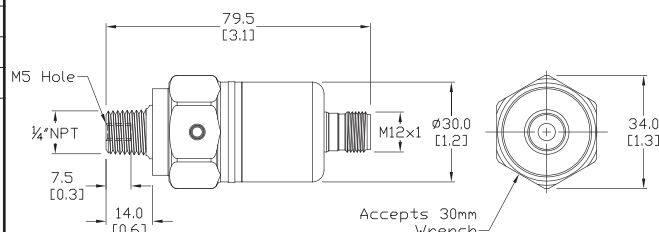

Note: tightening torque 25 Nm (18.4 lb-ft)

Dimensions shown mm [inches]

## PTD25-10 Wiring Diagrams



Cable Assembly Wiring Colors:  
Pin 1 - Brown  
Pin 2 - White  
Pin 3 - Blue  
Pin 4 - Black

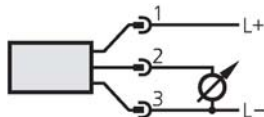

See Proximity Sensor section for cable specs

Note: wiring colors are based on AutomationDirect CD12L and CD12M 4-pole cable assemblies.

## PTD25-20 Wiring Diagrams



Cable Assembly Wiring Colors:  
Pin 1 - Brown  
Pin 2 - White  
Pin 3 - Blue  
Pin 4 - Black

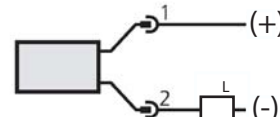

See Proximity Sensor section for cable specs



**WARNING! AVOID STATIC AND DYNAMIC OVERPRESSURE EXCEEDING THE GIVEN OVERLOAD PRESSURE.**

**EXCEEDING THE BURSTING PRESSURE FOR EVEN A SHORT TIME CAN CAUSE DESTRUCTION OF THE UNIT AND POSSIBLE INJURIES!**

## Pressure Units Conversion Chart

Pressure Conversion Table: Multiplication Factors										
Desired Units	Known Units									
		<i>Atmos</i>	<i>Bars</i>	<i>In of Hg (0°C)</i>	<i>In of H<sub>2</sub>O (4°C)</i>	<i>K grams/meter<sup>2</sup></i>	<i>Lb/in<sup>2</sup> (psi)</i>	<i>Lb/ft<sup>2</sup></i>	<i>mm of Hg torr</i>	<i>Pascals</i>
	<i>Atmos</i>	1	9.86923 x 10 <sup>-1</sup>	3.34207 x 10 <sup>-2</sup>	2.458 x 10 <sup>-3</sup>	9.678 x 10 <sup>-5</sup>	0.068046	4.7254 x 10 <sup>-4</sup>	1.316 x 10 <sup>-3</sup>	9.869 x 10 <sup>-6</sup>
	<i>Bars</i>	1.01325	1	3.3864 x 10 <sup>-2</sup>	2.491 x 10 <sup>-3</sup>	9.8067 x 10 <sup>-5</sup>	6.8948 x 10 <sup>-2</sup>	4.788 x 10 <sup>-4</sup>	1.333 x 10 <sup>-3</sup>	10 <sup>-5</sup>
	<i>In of Hg (0°C)</i>	29.9213	29.53	1	7.355 x 10 <sup>-2</sup>	2.896 x 10 <sup>-3</sup>	2.036	0.014139	3.937 x 10 <sup>-2</sup>	2.953 x 10 <sup>-4</sup>
	<i>In of H<sub>2</sub>O (4°C)</i>	406.8	401.46	13.60	1	3.937 x 10 <sup>-2</sup>	27.68	0.1922	0.5354	4.014 x 10 <sup>-3</sup>
	<i>K grams/meter<sup>2</sup></i>	1.033227 x 10 <sup>4</sup>	1.0197 x 10 <sup>4</sup>	345.3	25.40	1	7.0306 x 10 <sup>2</sup>	4.882	13.59	1.019 x 10 <sup>-1</sup>
	<i>Lb/in<sup>2</sup> (psi)</i>	14.695595	14.504	0.4912	3.6126 x 10 <sup>-2</sup>	1.423 x 10 <sup>-3</sup>	1	6.9444 x 10 <sup>-3</sup>	1.934 x 10 <sup>-2</sup>	1.450 x 10 <sup>-4</sup>
	<i>Lb/ft<sup>2</sup></i>	2116.22	2088.5	70.726	5.202	0.2048	144.0	1	2.7844	2.089 x 10 <sup>-2</sup>
	<i>mm of Hg torr</i>	760	750.06	25.400	1.868	7.3558 x 10 <sup>-2</sup>	51.715	0.35913	1	7.502 x 10 <sup>-3</sup>
	<i>Pascals</i>	1.01325 x 10 <sup>5</sup>	1 x 10 <sup>5</sup>	3.386 x 10 <sup>3</sup>	2.491 x 10 <sup>2</sup>	9.8067	6.8948 x 10 <sup>3</sup>	4.788 x 10 <sup>1</sup>	1.333 x 10 <sup>2</sup>	1
Example: To convert from 50 psi to "In of H <sub>2</sub> O", (50 psi) (27.68) = 1384 In of H <sub>2</sub> O										